



 LORENZOLINE

**100WP**

Wall Partition System | Ofis Bölme Sistemi

# 100WP

## WALL PARTITION SYSTEM OFİS BÖLME SİSTEMİ

- Assembly can be done in a short time, thanks to most of the manufacturing can be done in the workshop.
- It offers quick installation thanks to the mounting of the panels with clips.
- It is compatible with all doors of the 24D system.
- Thanks to the corner turning profile, different office types can be created.
- Venetian blind can be installed if desired.

- İmalatın çoğunun atölyede yapılabilmesi ile kısa sürede montaj yapılabilir.
- Panellerin klips ile montajı sayesinde hızlı montaj imkanı sunar.
- 24D sisteminin tüm kapılarıyla uyumludur.
- Köşe dönüş profili sayesinde farklı ofis tipleri oluşturulabilir.
- İstenildiğinde jaluzi konulabilir.

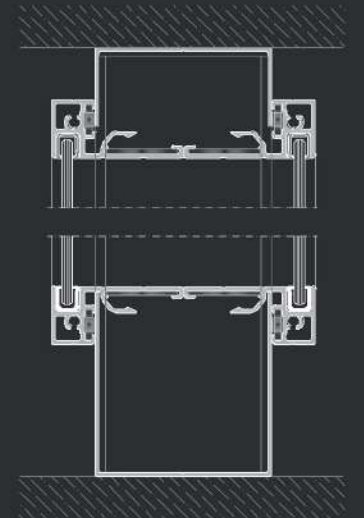
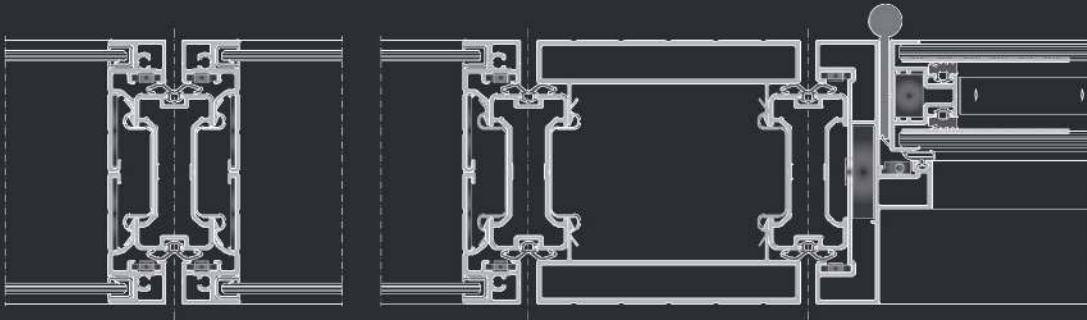

PROFILES  
PROFILLER

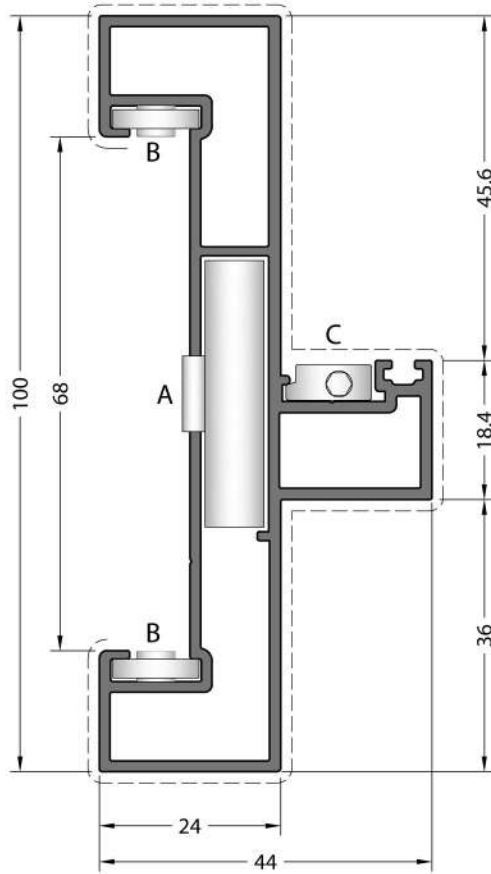

**CODE / KOD**

**100WP-101-00**

**THEORETICAL WEIGHT**

TEORİK AĞIRLIK ( kg/m )

**1.403**



**A** LC-0936



**B** MK100WP-202



**C** LC-122

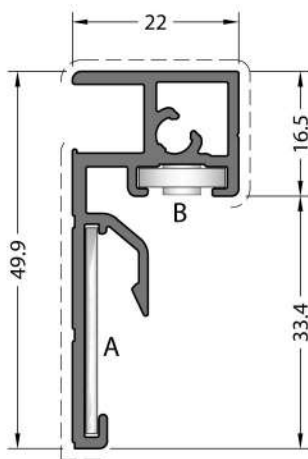

**CODE / KOD**

**100WP-201-00**

**THEORETICAL WEIGHT**

TEORİK AĞIRLIK ( kg/m )

**0.578**

**CORNER JOINT**

KÖŞE BAĞLANTI



**A** 14-119-015  
(27.2 mm)



**B** MK100WP-202

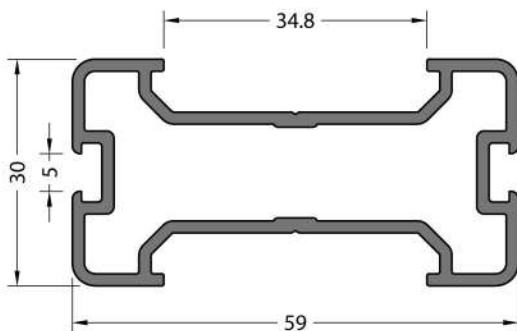

**No visible surface.**

Görünen yüzeyi yoktur.

**CODE / KOD**

**100WP-301-00**

**THEORETICAL WEIGHT**

TEORİK AĞIRLIK ( kg/m )

**0.933**

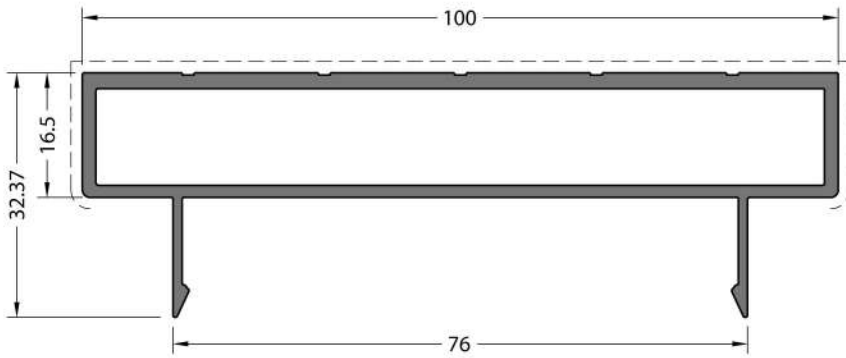

CODE / KOD

**100WP-401-00**

THEORETICAL WEIGHT  
TEORİK AĞIRLIK (kg/m)

**1.224**

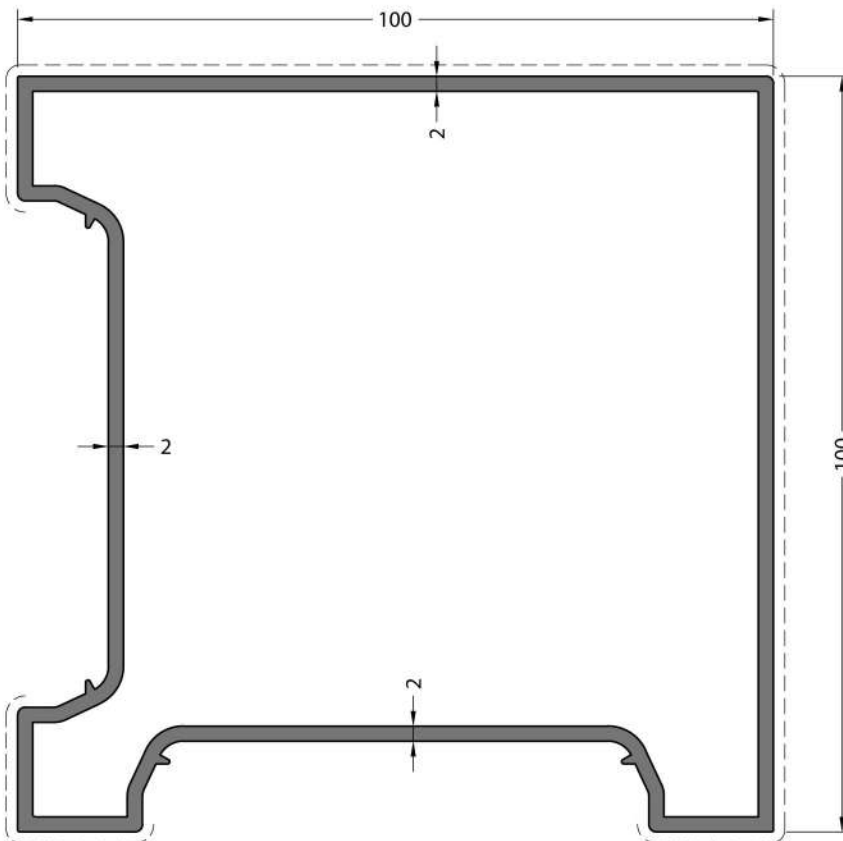

CODE / KOD

**100WP-501-00**

THEORETICAL WEIGHT  
TEORİK AĞIRLIK (kg/m)

**2.314**

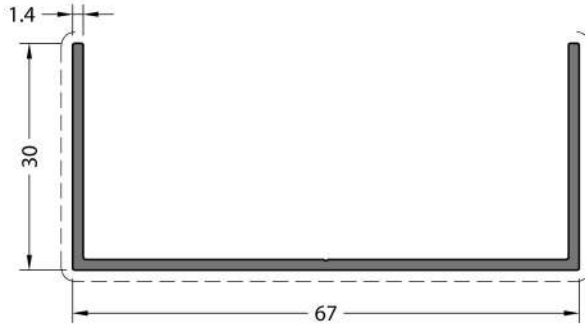

**CODE / KOD**

**15-194-014**

**THEORETICAL WEIGHT**  
TEORİK AĞIRLIK ( kg/m )

**0.469**

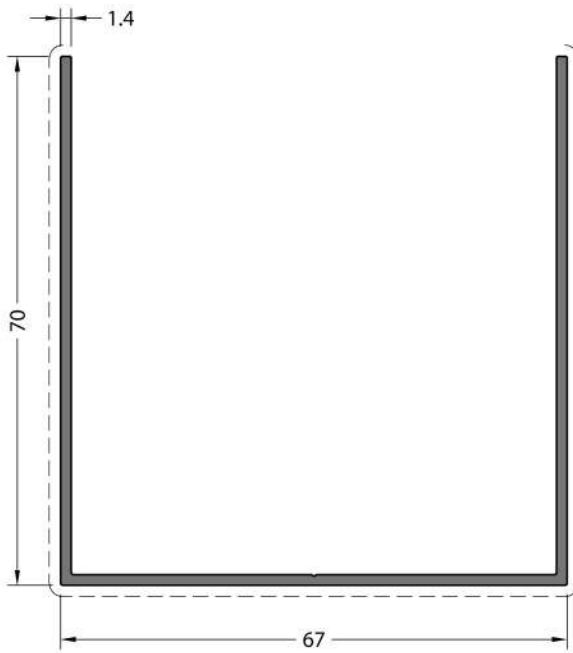

**CODE / KOD**

**15-195-014**

**THEORETICAL WEIGHT**  
TEORİK AĞIRLIK ( kg/m )

**0.771**

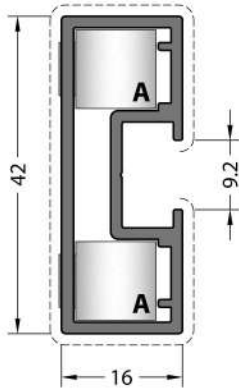

CODE / KOD

**24D-271-00**

THEORETICAL WEIGHT

TEORİK AĞIRLIK (kg/m)

**0.552**

CORNER JOINT

KÖŞE BAĞLANTI



**A** KC-801-10.5  
(27.2 mm)

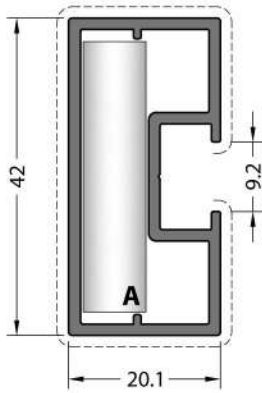

CODE / KOD

**24D-272-00**

THEORETICAL WEIGHT

TEORİK AĞIRLIK (kg/m)

**0.574**

CORNER JOINT

KÖŞE BAĞLANTI



**A** LC-0936

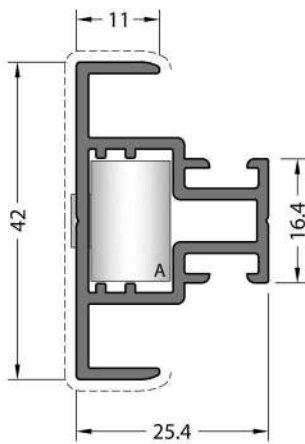

CODE / KOD

**24D-261-00**

THEORETICAL WEIGHT

TEORİK AĞIRLIK (kg/m)

**0.594**

CORNER JOINT

KÖŞE BAĞLANTI



**A** CC-101-16.0

MECHANICAL CORNER JOINT

MEKANİK KÖŞE BAĞLANTI



**A** KC-801-16.0

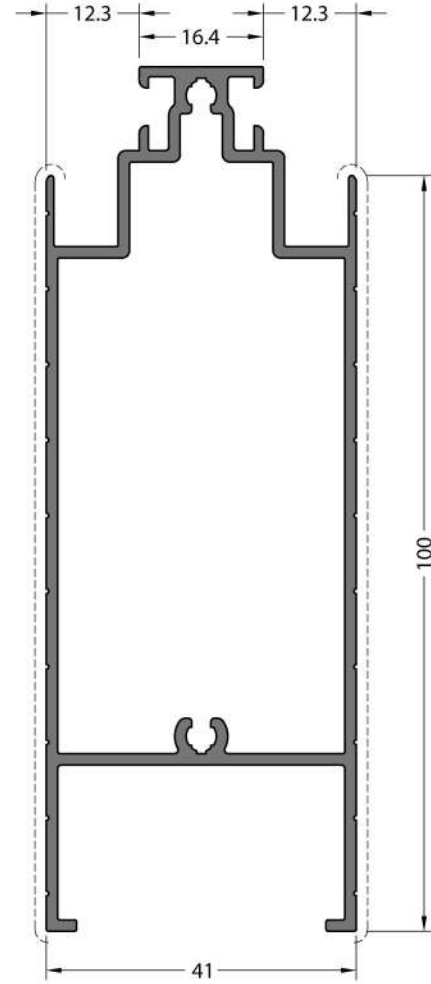

CODE / KOD

**24D-262-00**

THEORETICAL WEIGHT

TEORİK AĞIRLIK (kg/m)

**1.410**

DETAILS  
DETAYLAR

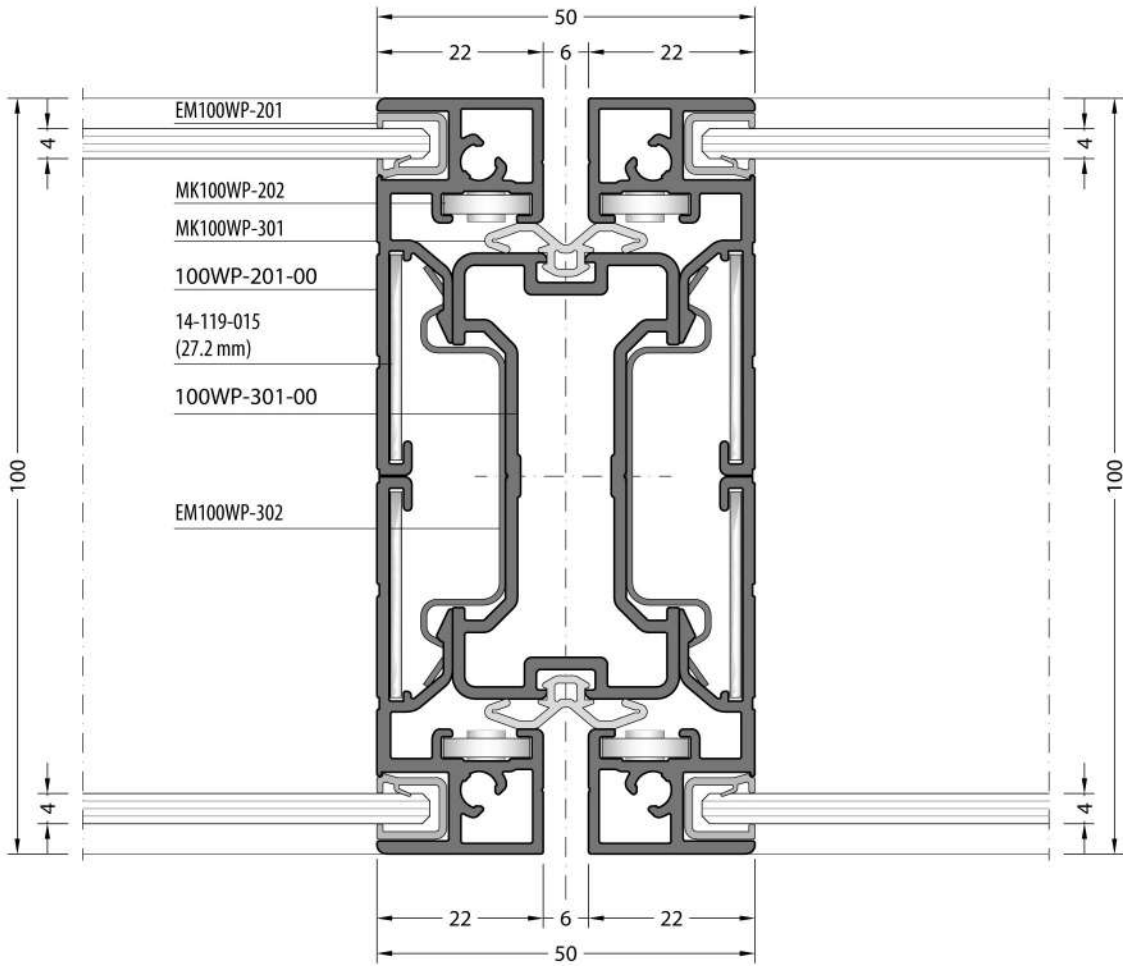
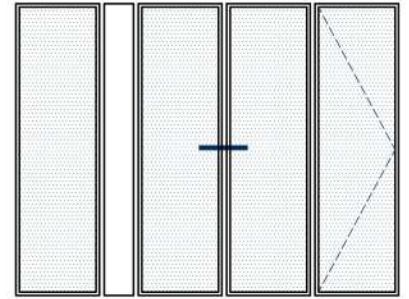

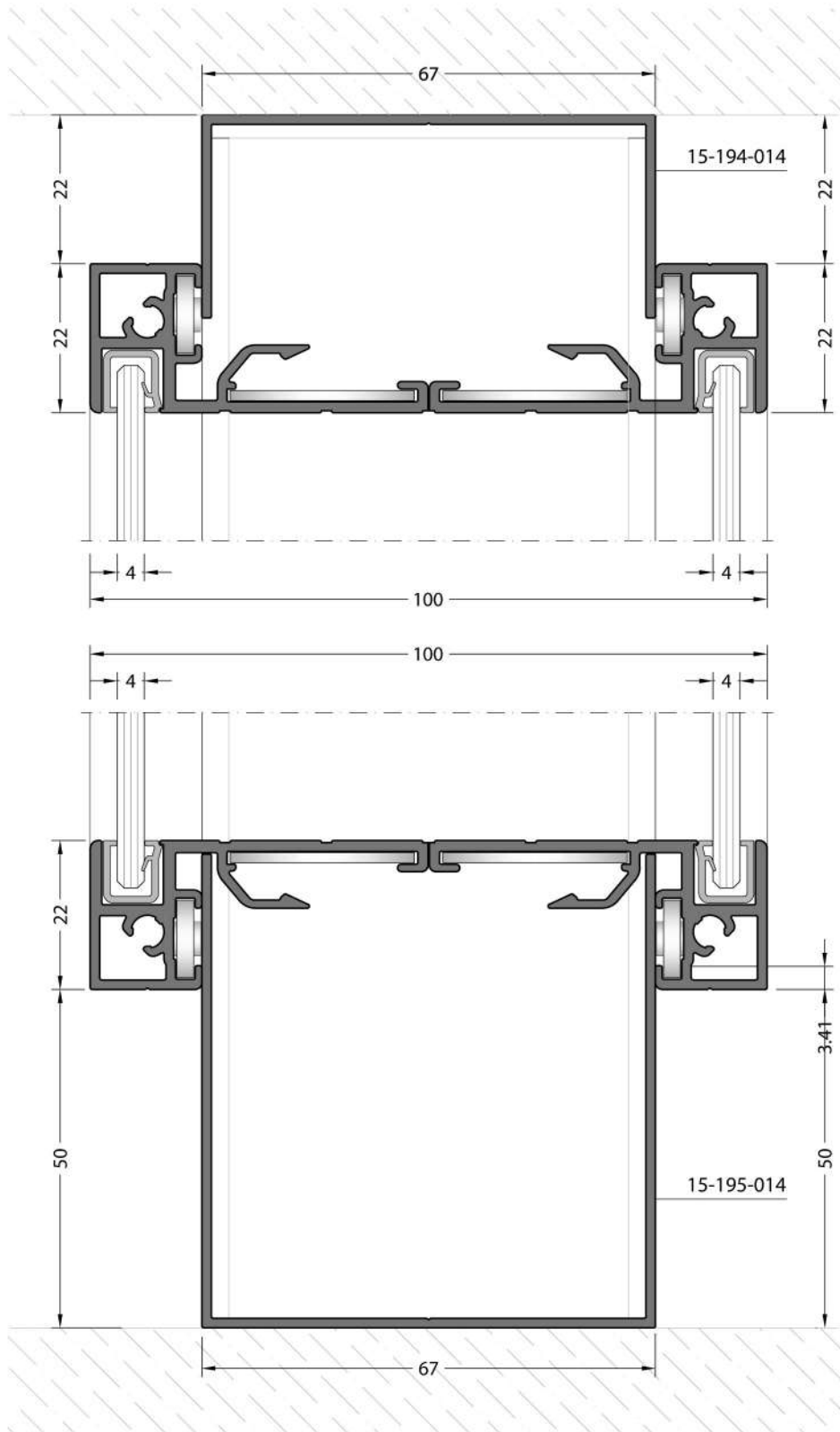
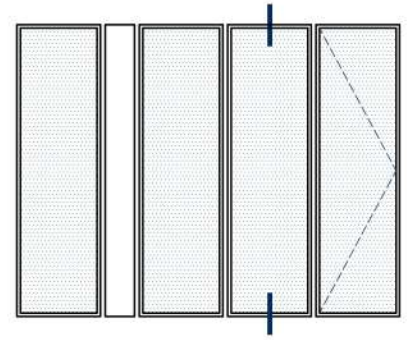

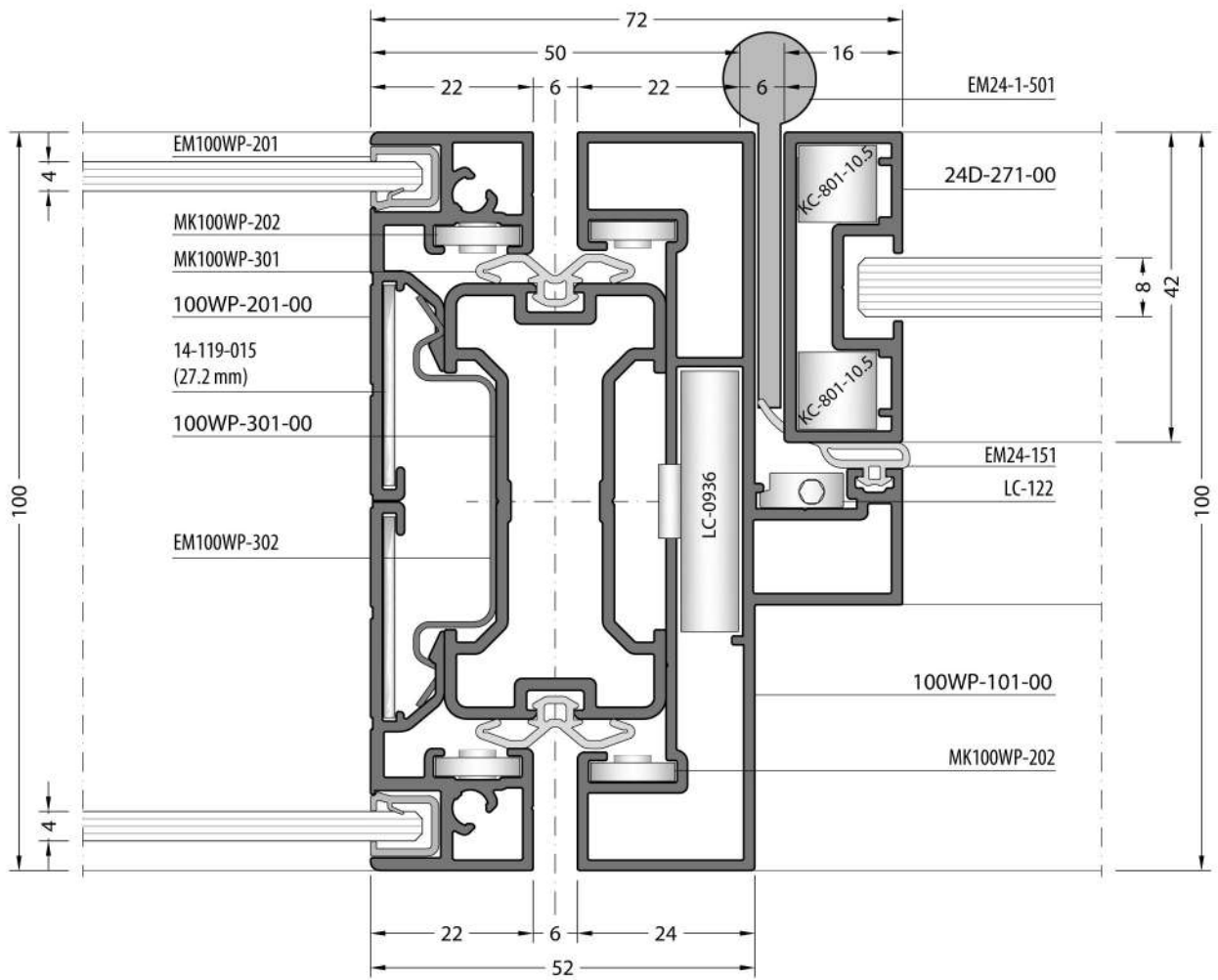
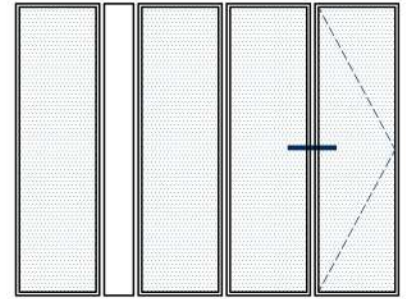

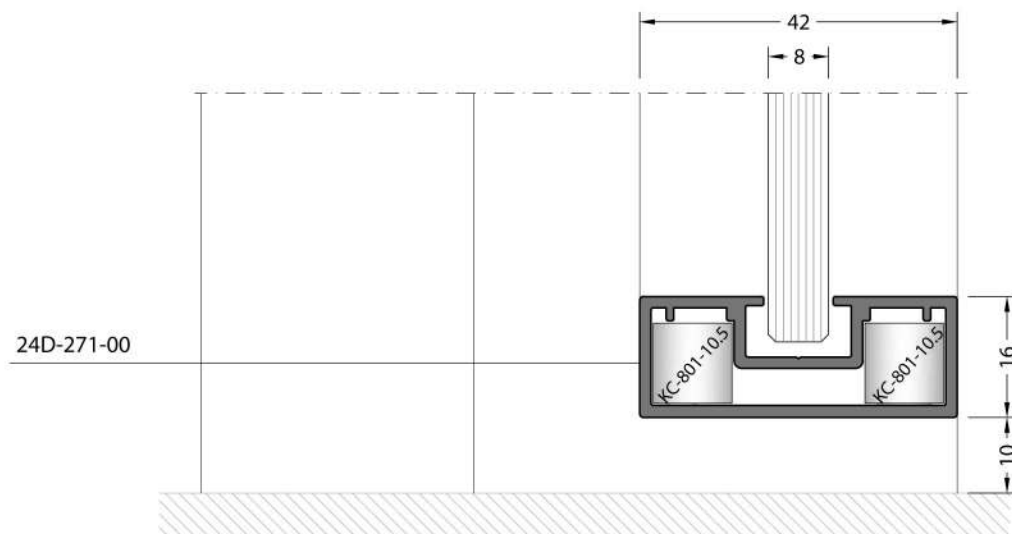
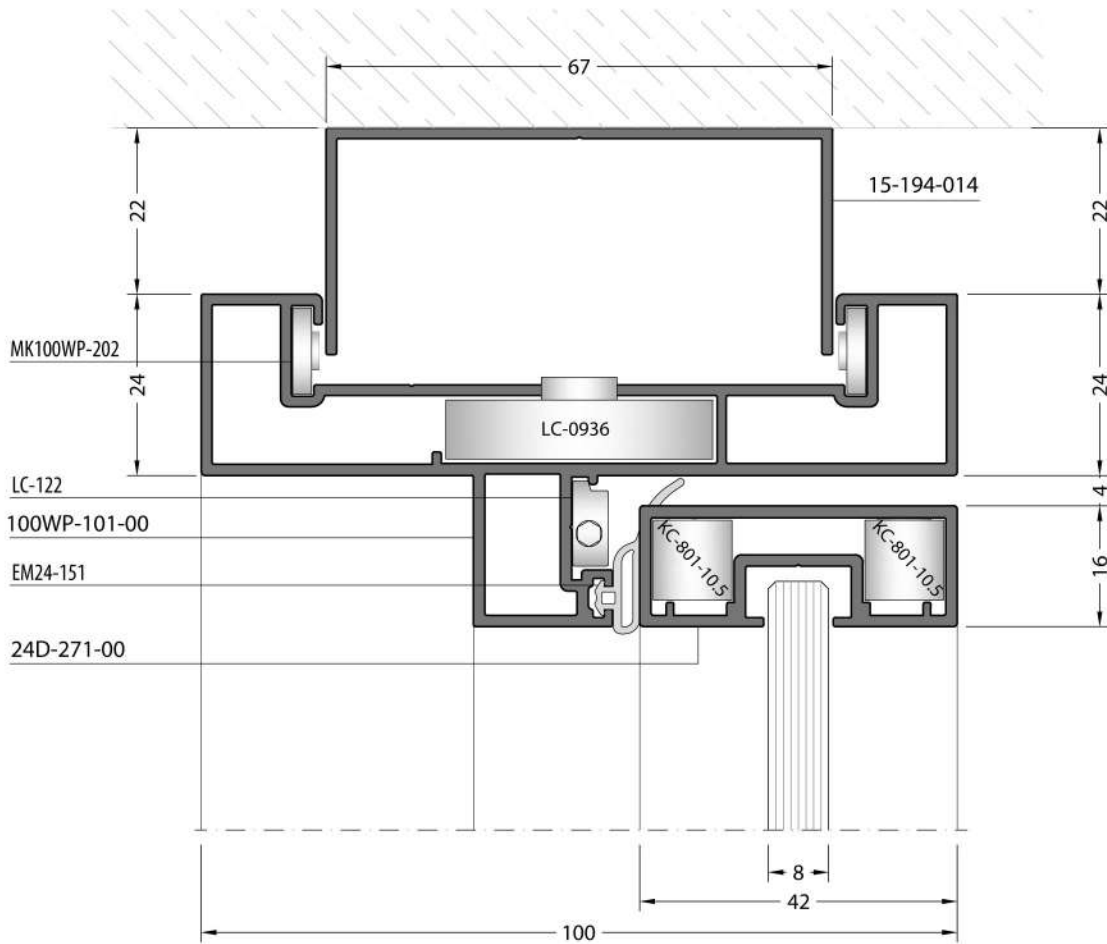
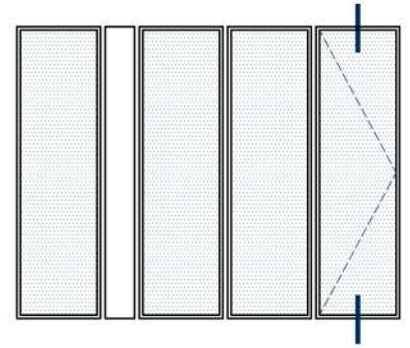

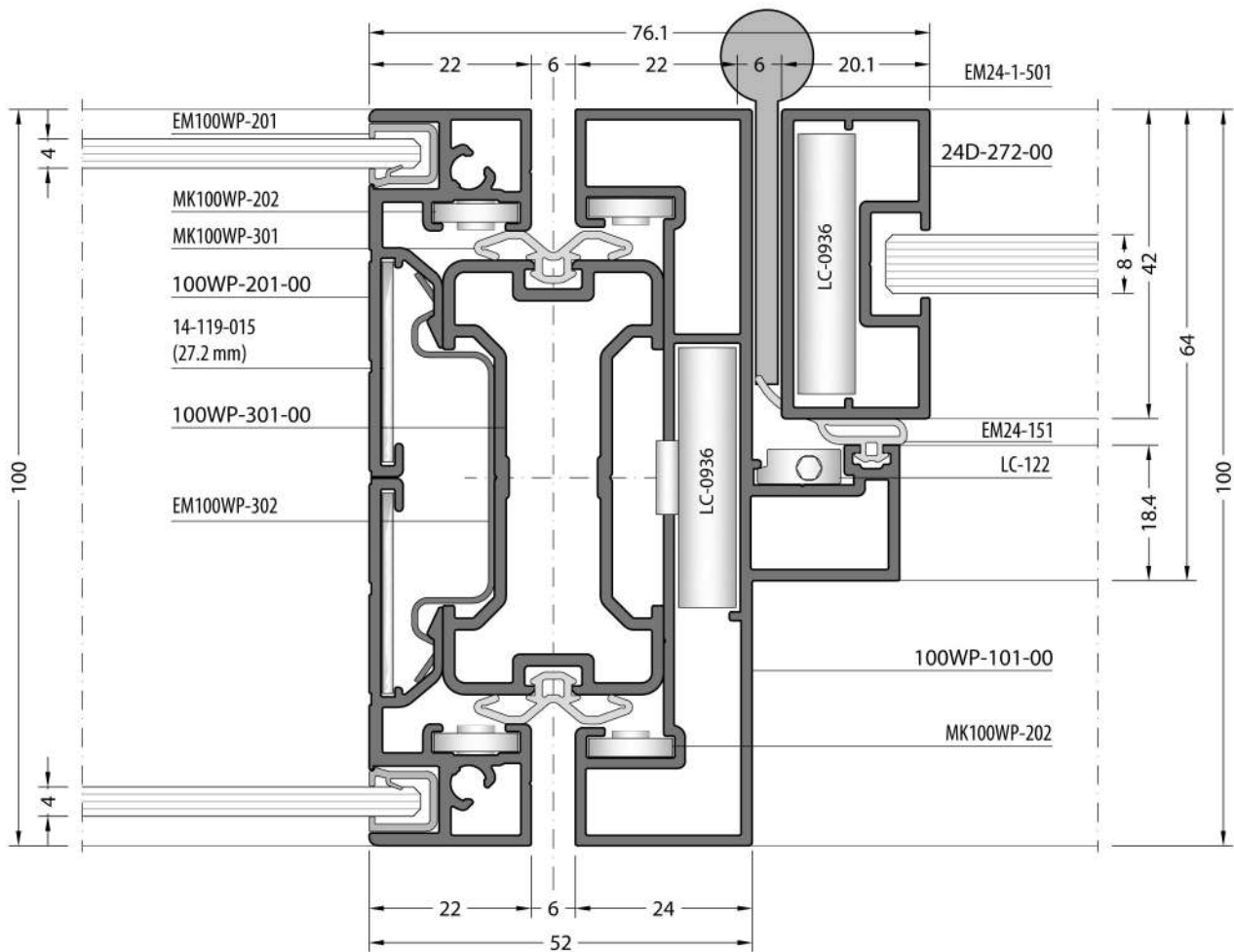
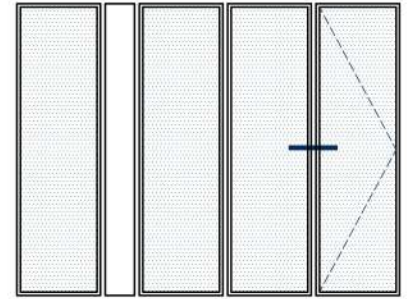

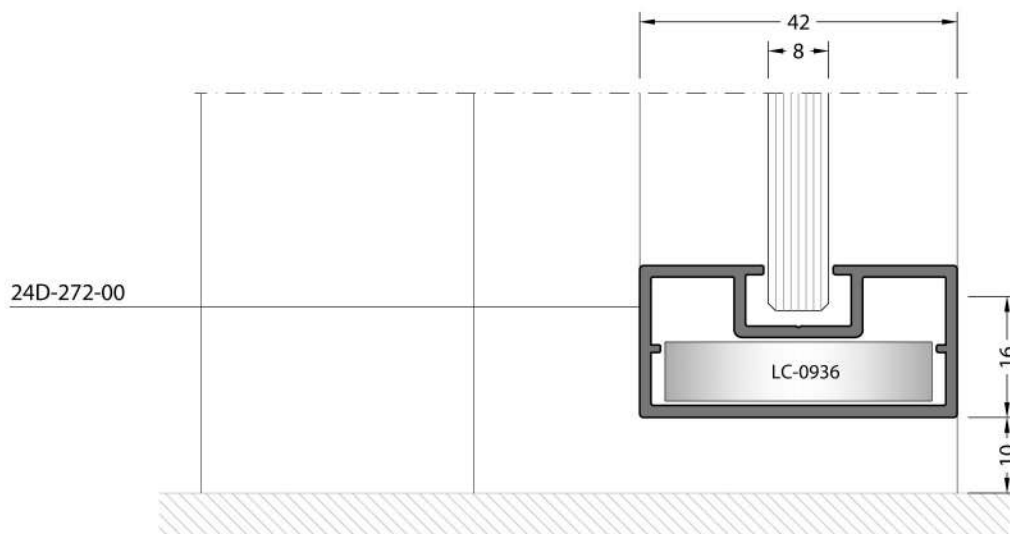
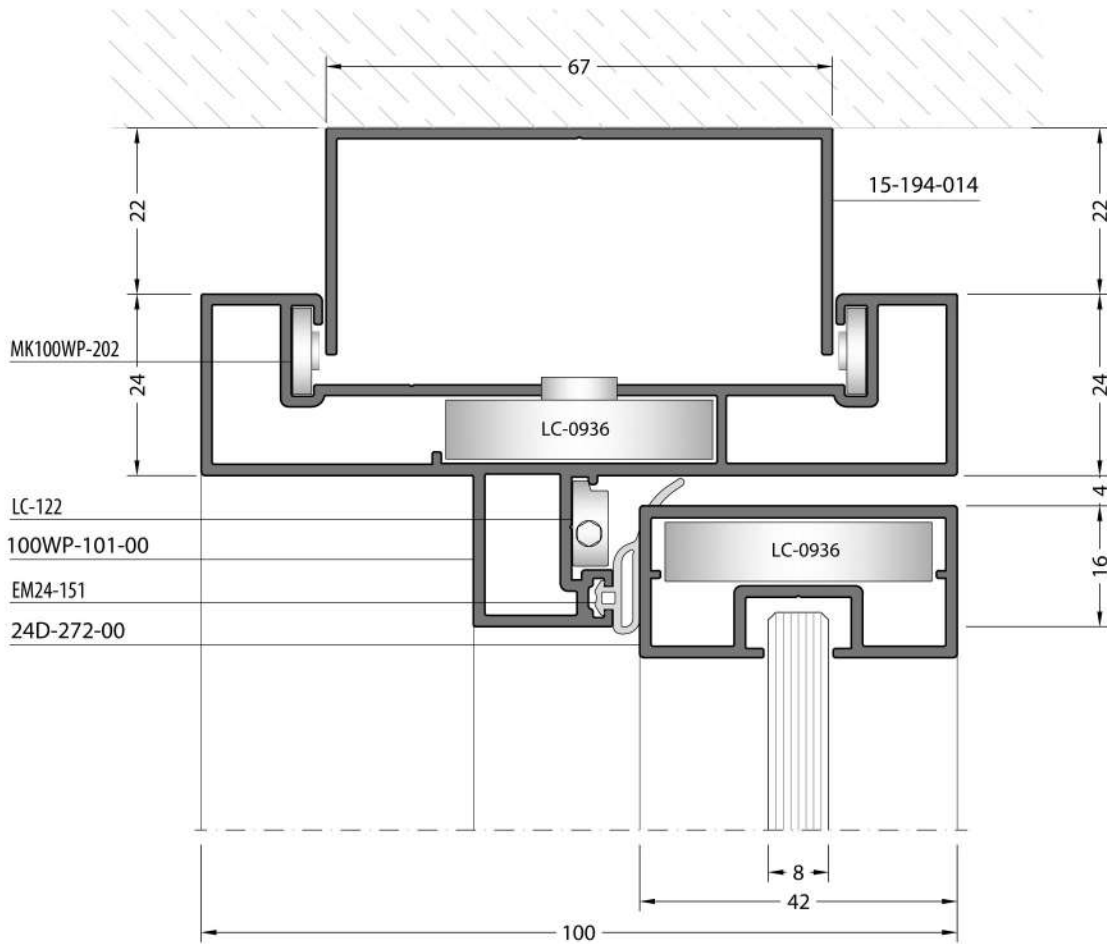
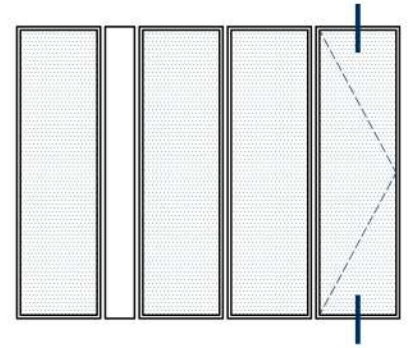

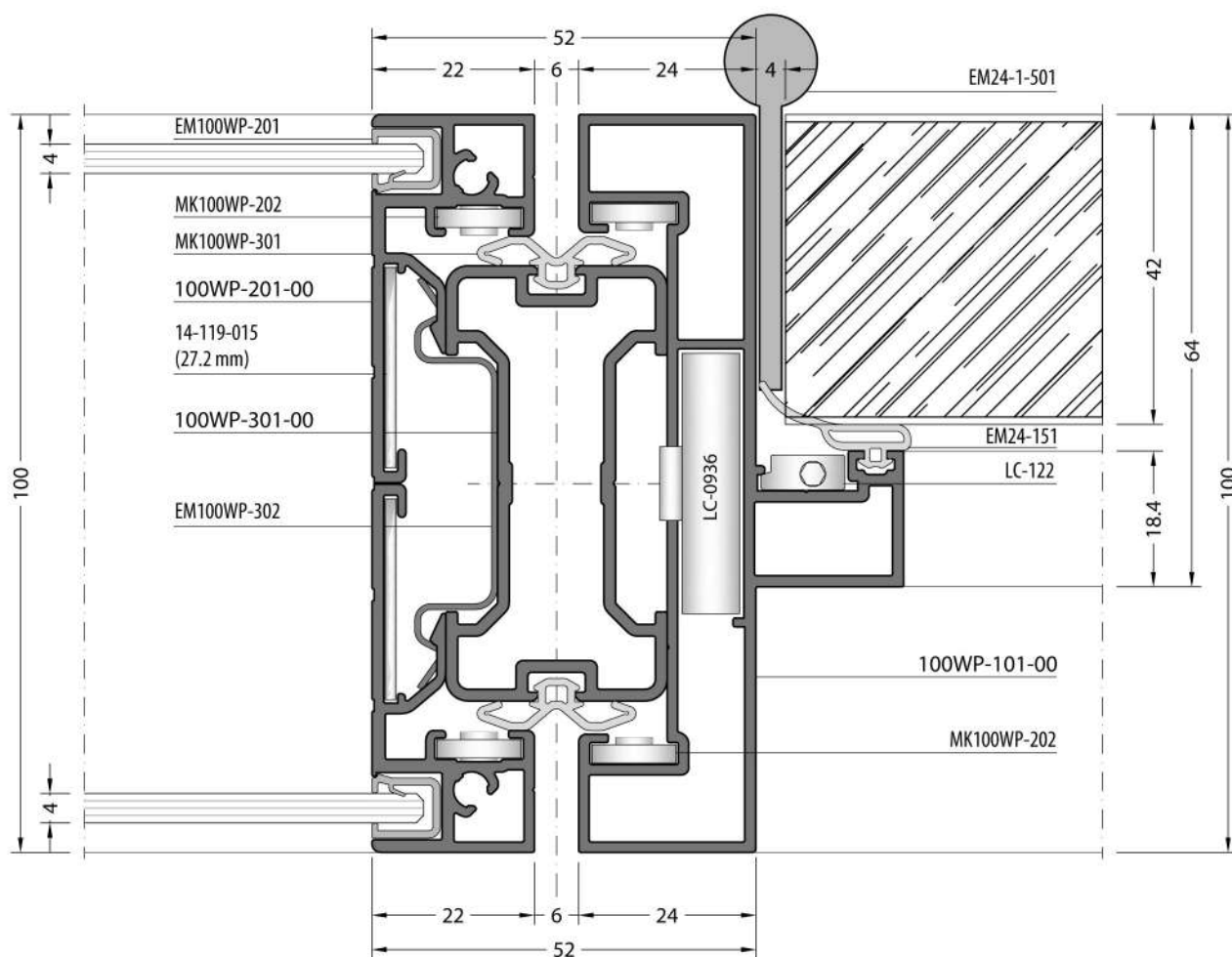
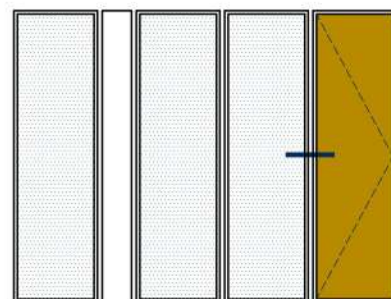

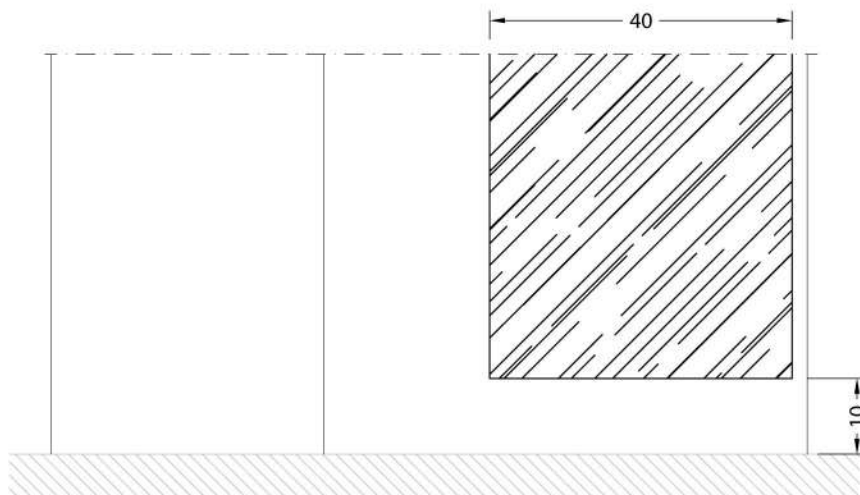
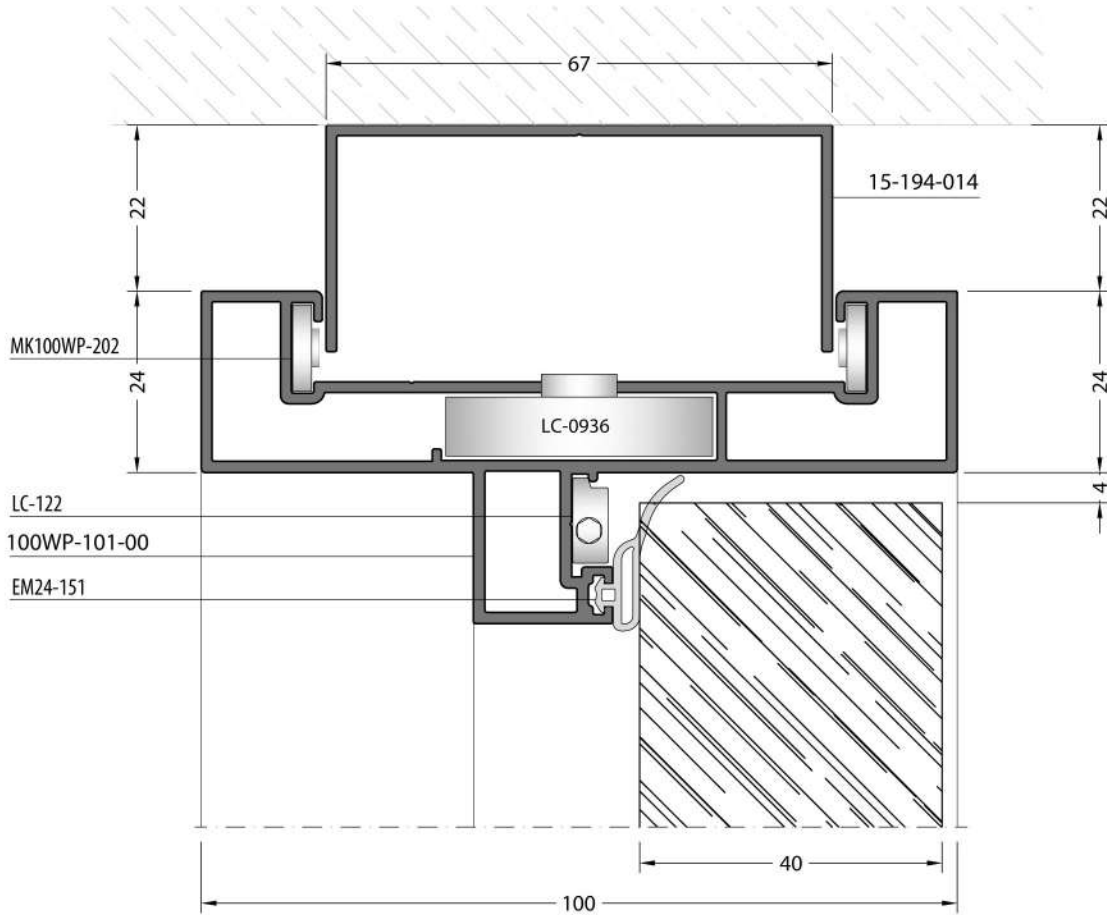
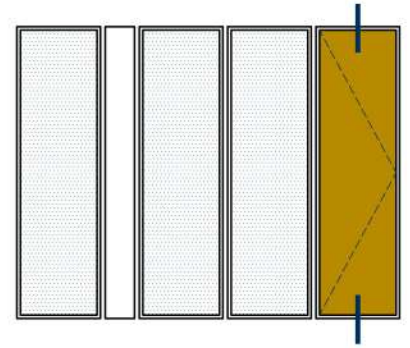

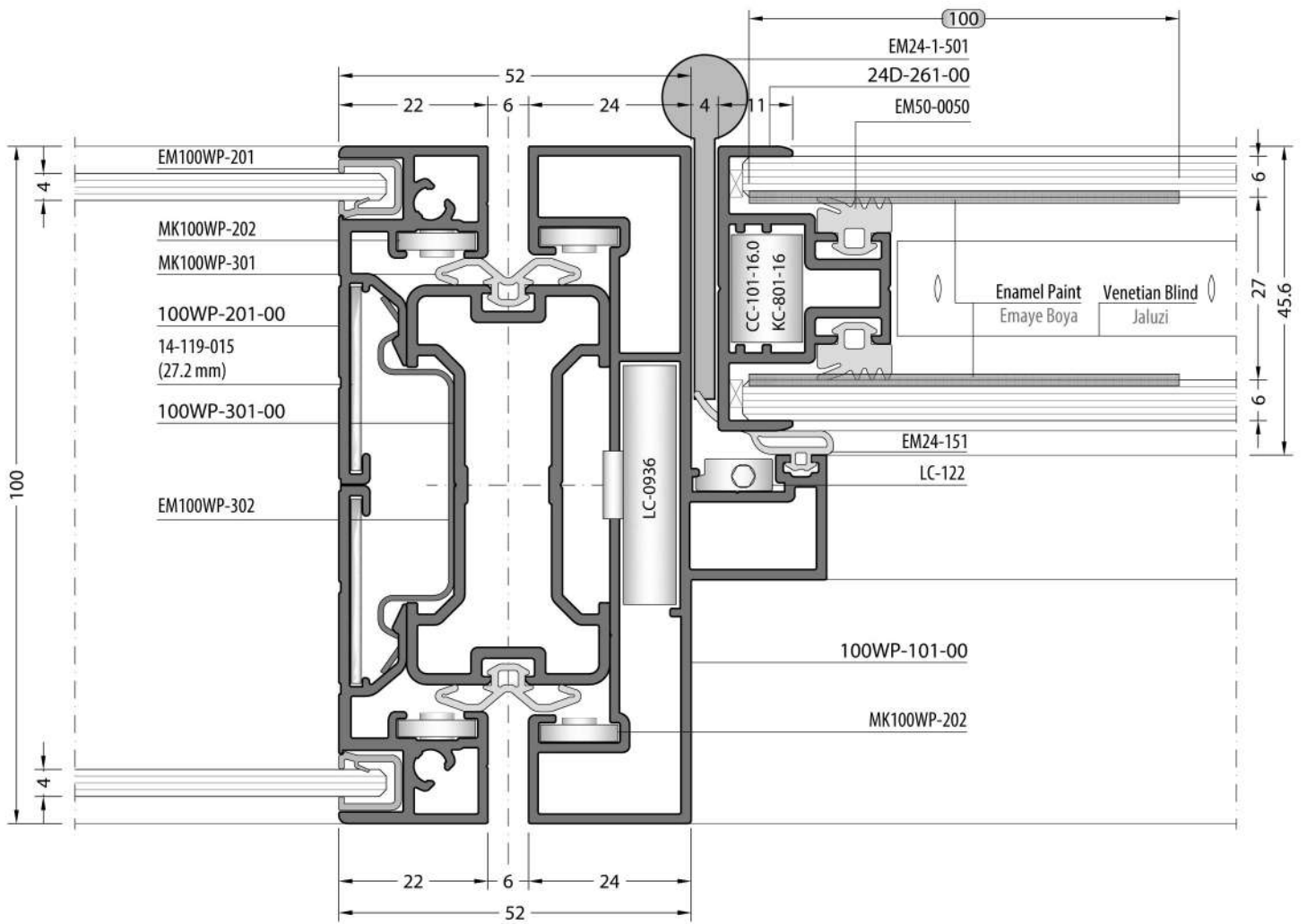
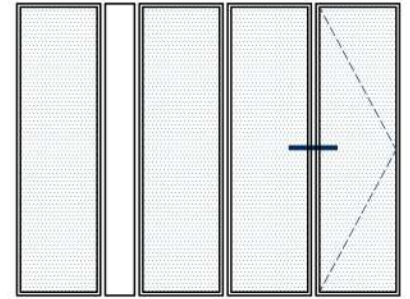

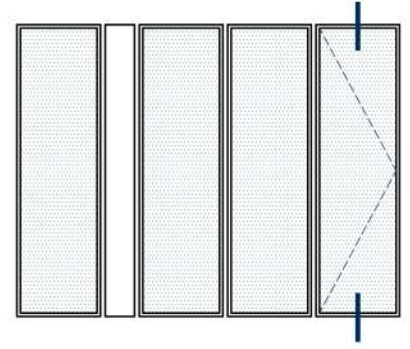
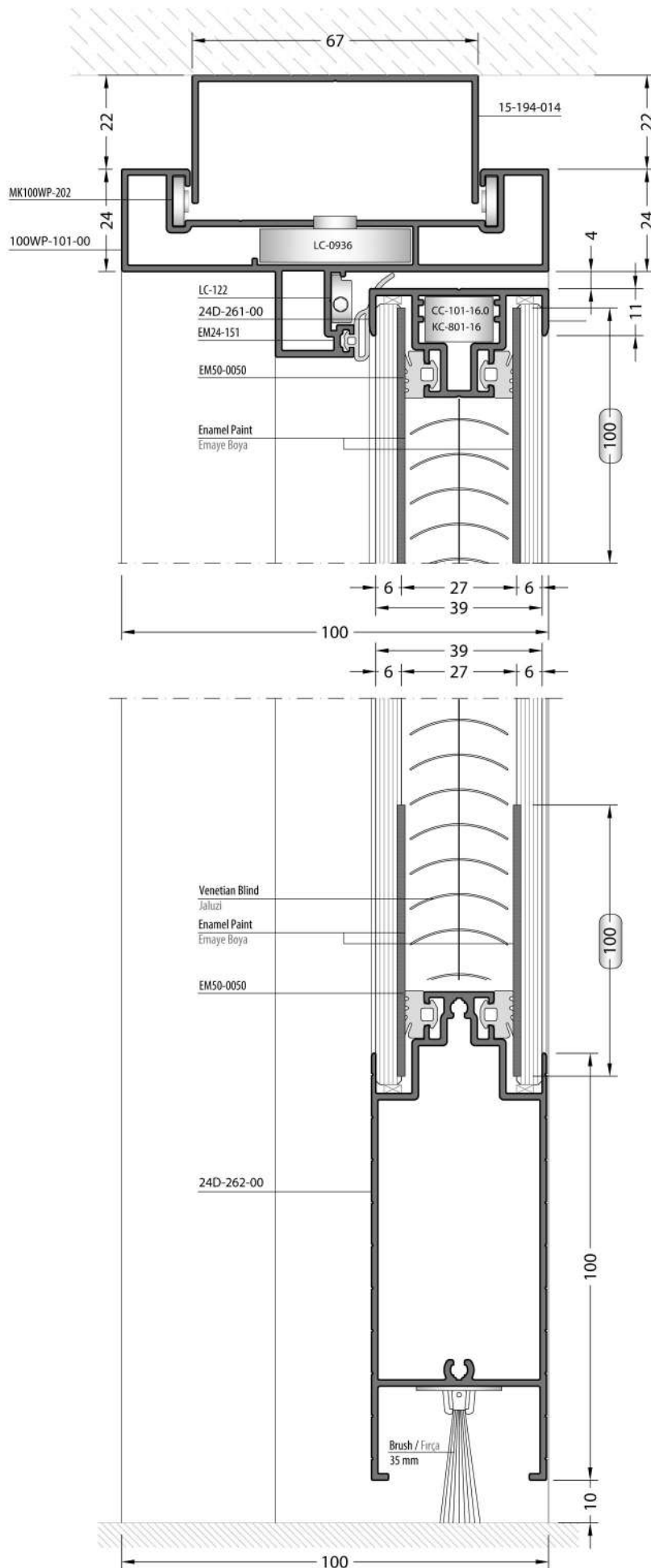

No scaled / Ölçeksiz

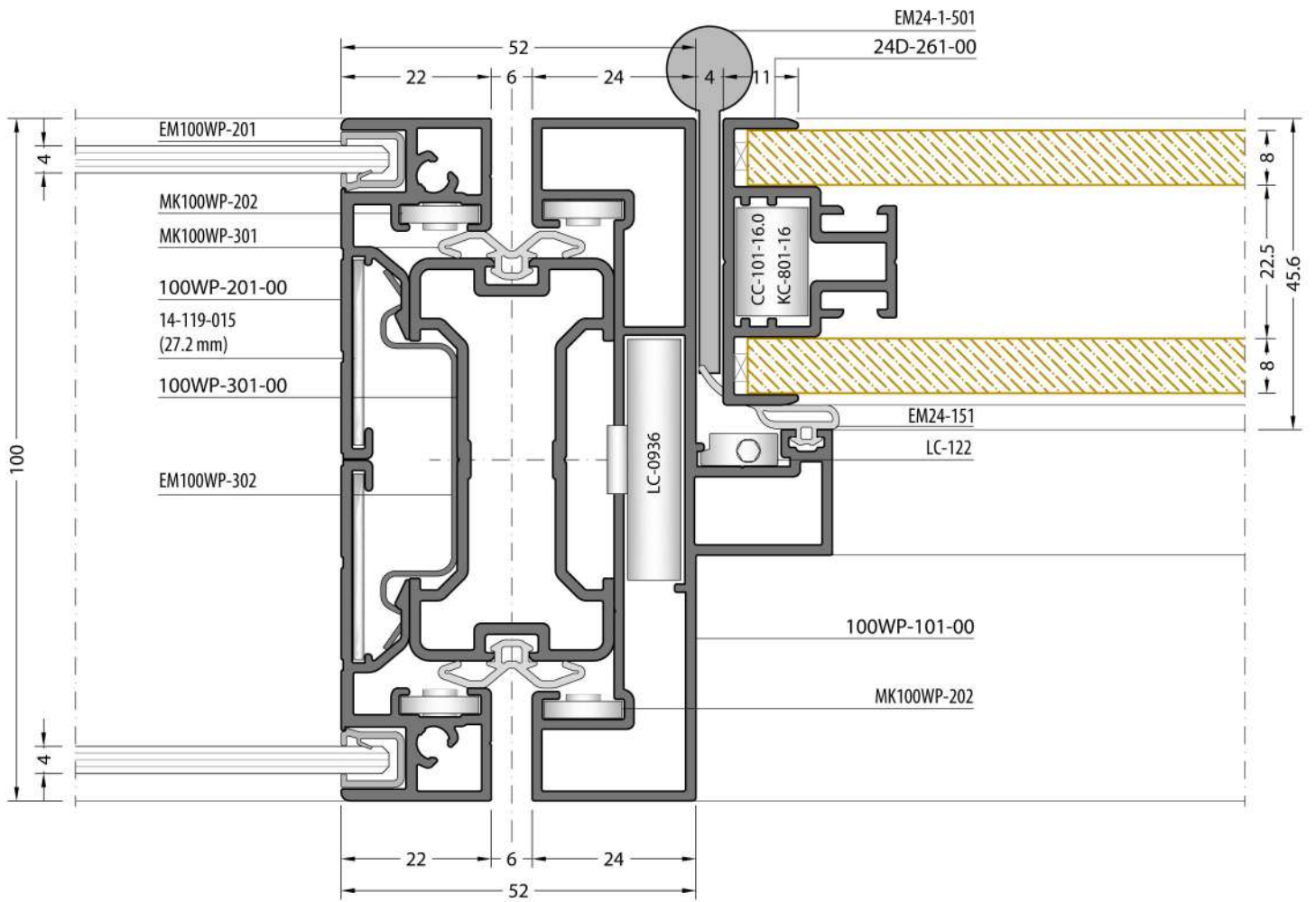
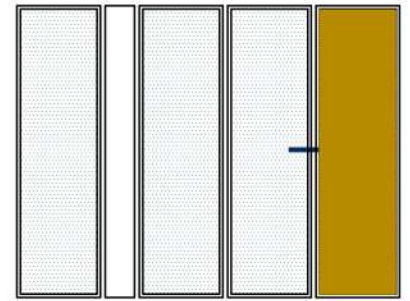



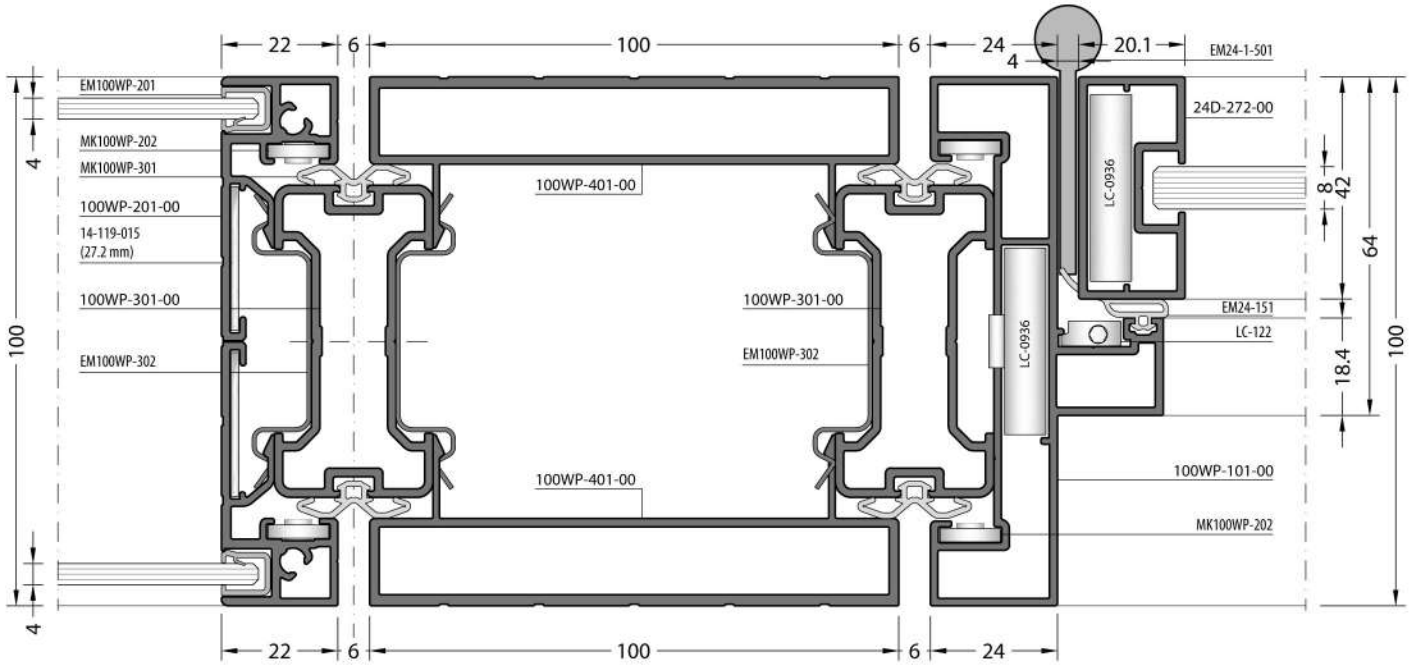
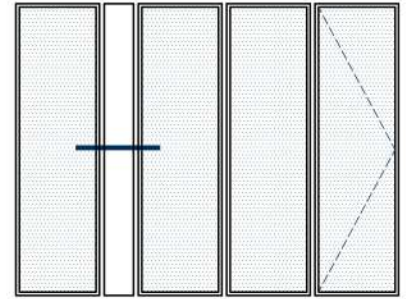

**No scaled / Ölçeksiz**

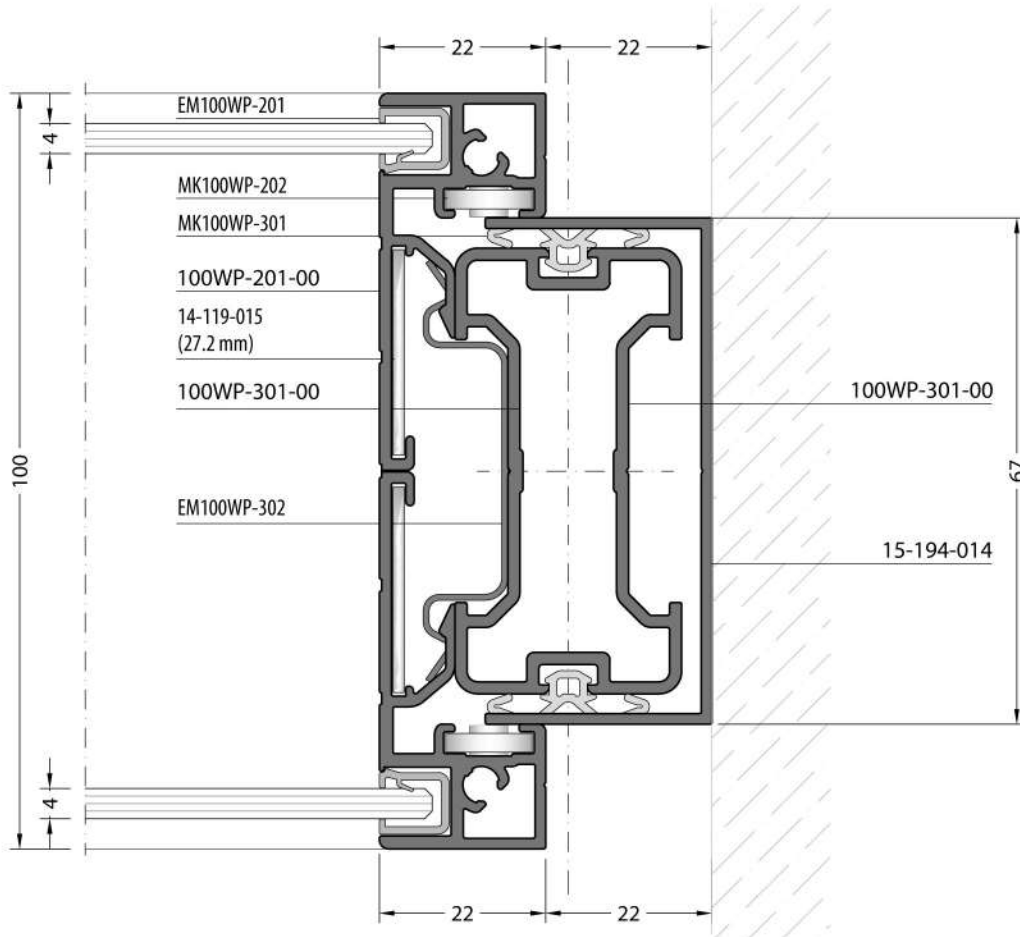
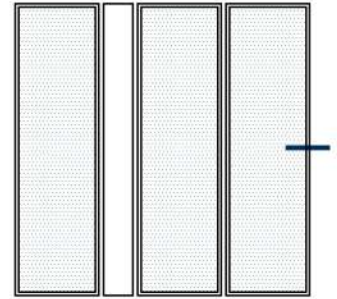

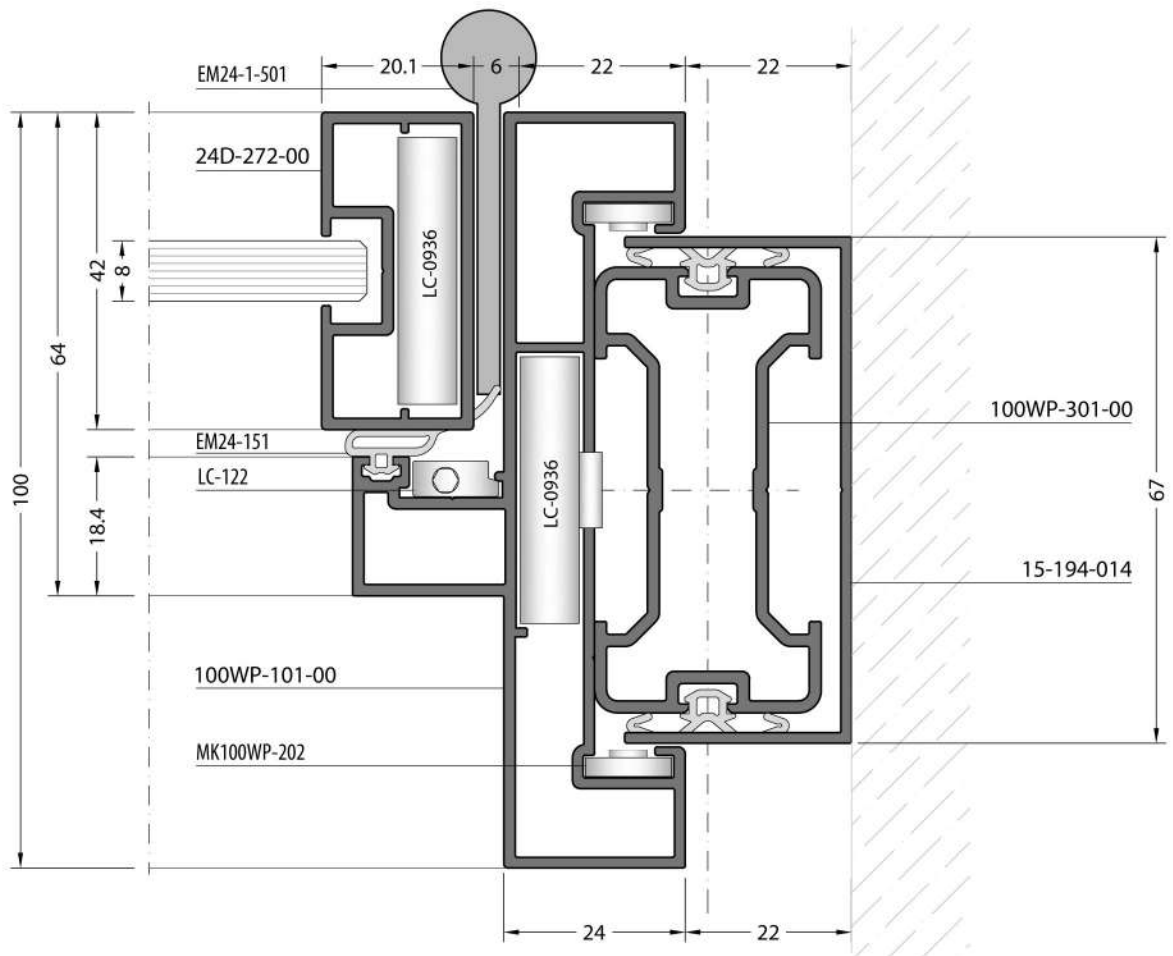
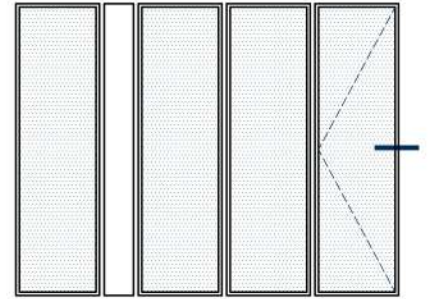

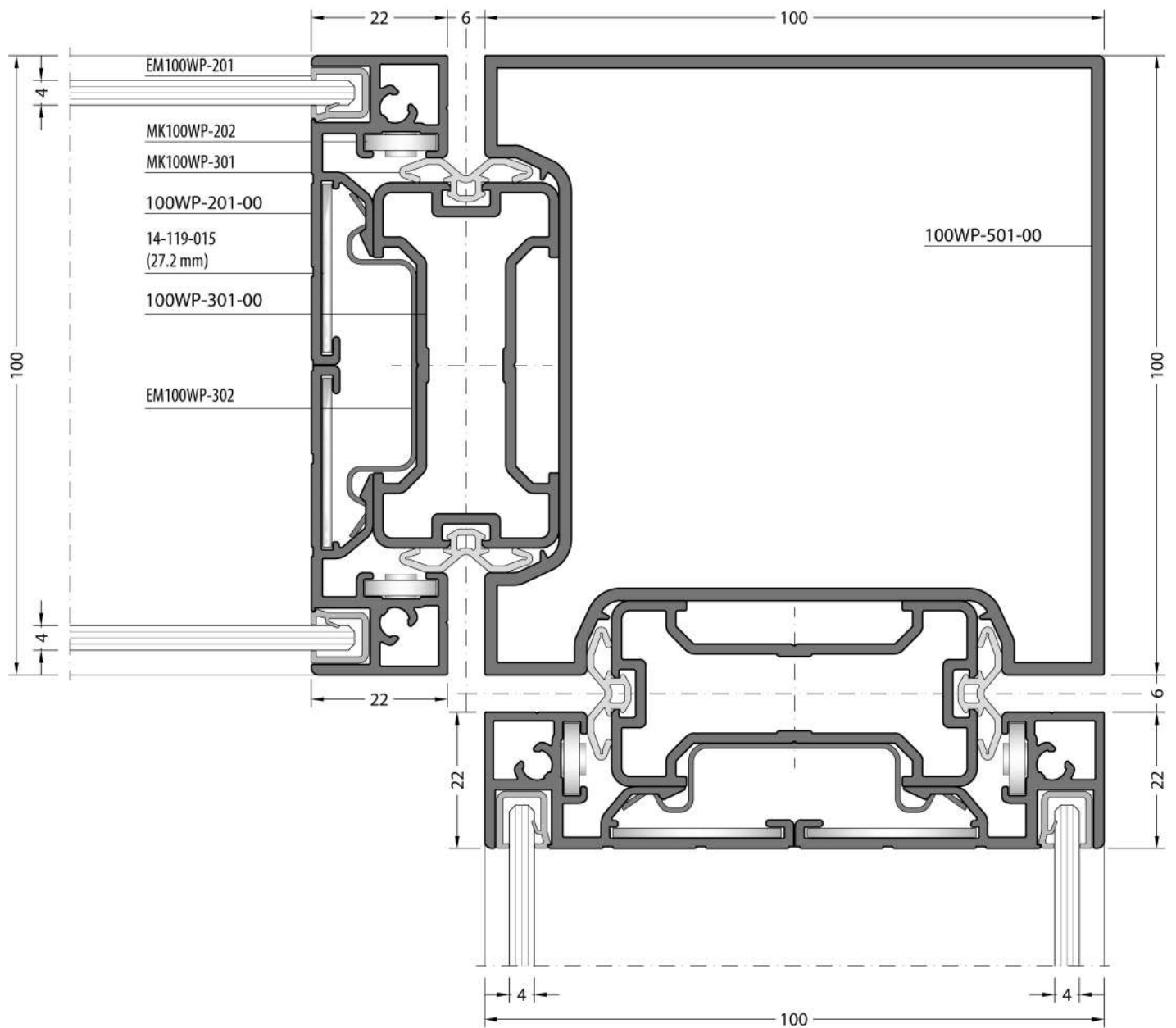
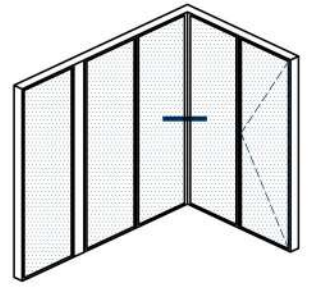





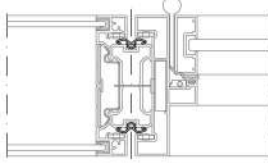

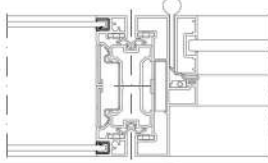

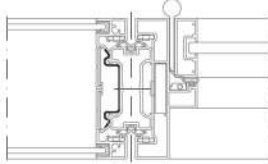



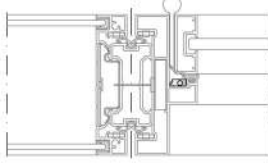

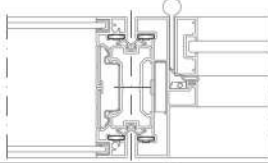

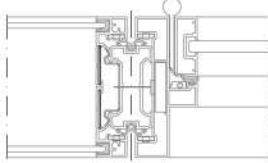
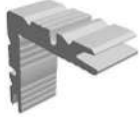
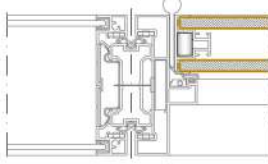
ACCESSORIES  
AKSESUARLAR

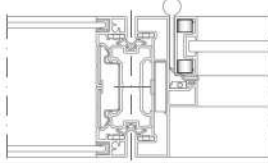
**ACCESSORIES / AKSESUARLAR**

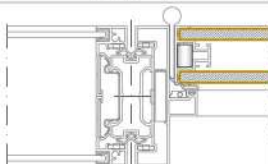
CODE / KOD	DRAWING / ÇİZİM	APPLICATION / UYGULAMA	DESCRIPTION / AÇIKLAMA
EM100WP-301			<b>EPDM GASKET</b> EPDM FİTİL
EM100WP-201			<b>PVC PROFILE</b> PVC PROFİL <b>(3 Meter / Metre)</b>
EM100WP-302			<b>PANEL HOLDER</b> PANEL TUTUCU
LC-0936			<b>DIE-CAST CORNER JOINT</b> PİMLİ BAĞLANTI
LC-122			<b>CORNER JOINT</b> KÖŞE BAĞLANTI
MK100WP-202			<b>CORNER JOINT</b> KÖŞE BAĞLANTI
14-119-015 (27.2 mm)			<b>CORNER JOINT</b> KÖŞE BAĞLANTI
CC-101-16.0			<b>CORNER JOINT</b> KÖŞE BAĞLANTI
KC-801-10.5			<b>CORNER JOINT</b> KÖŞE BAĞLANTI
KC-801-16.0			<b>CORNER JOINT</b> KÖŞE BAĞLANTI

